



MAILING ADDRESS:

**PO BOX 506
PLEASANT UNITY, PA 15676**

PHONE: 724-423-6888

FAX: 724-423-6878

SHIPPING ADDRESS:

**370 PLEASANT UNITY MUTUAL ROAD
GREENSBURG, PA 15601**

**SEWAGE PERMIT
2008284**

The Unity Township Municipal Authority does hereby issue a Sewage Permit to:

RITA KUBA

for the purpose of tapping into the sewer system of Unity Township at:

VACANT LOT, LOT , MISSION ROAD

by reason of the construction of a: **HOUSE**

for the following number of taps: **1**

Receipt of the proper connection charge is hereby acknowledged and permission for the construction of the sewer connection is hereby granted, provided that all construction is made according to the Rules and Regulations of the Unity Township Municipal Authority and the Inspector of the Authority is notified prior to the start of construction and he has the opportunity to inspect the construction of the sewer tap-in in accordance with the Rules and Regulations. * **PROPERTY OWNER'S RESPONSIBILITY TO CONNECT INTO UTMA'S EXISTING 8" SANITARY SEWER ON THE OTHER SIDE OF MISSION ROAD ***

Dated this Thursday, December 18, 2008

Tax ID **61-14-13-0-021**

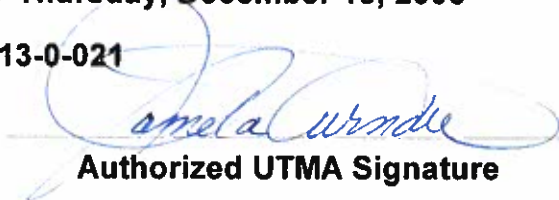

Authorized UTMA Signature

BUILDER: RITA KUBA

CONNECTION	\$0.00
TAPPING FEE	\$2,650.00
TOTAL FEE	\$2,650.00

**U.T.M.A.
PAID**

DATE 12/17/08 CASH _____ BY _____
CK# 25 AMT 2650.00

UNITY TOWNSHIP MUNICIPAL AUTHORITY
GREENSBURG, PENNSYLVANIA 15601

TAP- IN APPLICATION

PERMIT NO. _____
ISSUE DATE _____

PROPERTY OWNER NAME: Rita Kuba

ADDRESS: 1426 Anthony Street

CITY: Latrobe STATE: PA ZIP: 15650

CONTRACTOR / DEVELOPER NAME: _____

ADDRESS: _____

CITY: _____ STATE: _____ ZIP: _____

PROPERTY LOCATION

NAME OF DEVELOPMENT: _____

STREET / ROUTE / CITY: Mission Road Latrobe PA 15650

TAX MAP NUMBER: 61-14-13-0-021 LOT/DWELLING #: _____

BUILDING DESCRIPTION

TYPE OF BUILDING: _____

BUILDING USE: _____

ADDITIONAL INFORMATION: Property owner's responsibility to connect into UTMA's existing 8" sanitary sewer on the other side of Mission Road.

PHONE NUMBER(S): _____

DATE OF APPLICATION: 12/18/2008

SIGNATURE OF APPLICANT

DO NOT WRITE BELOW THIS LINE

UNITY SUPPLIED LATERAL: No NUMBER OF EDU'S: 1 - Latrobe

COMMERCIAL PROPERTY: No PREVIOUSLY ASSESSED: N/A

REBATE DUE: N/A REBATE DUE TO: N/A

HEMPFIELD TAP NO: N/A

UNITY TAPPING FEE: \$2,650.00

CONNECTION FEE: \$0.00

PREPAY: - \$0.00

TOTAL FEE DUE: \$2,650.00

APPROVED FOR UTMA

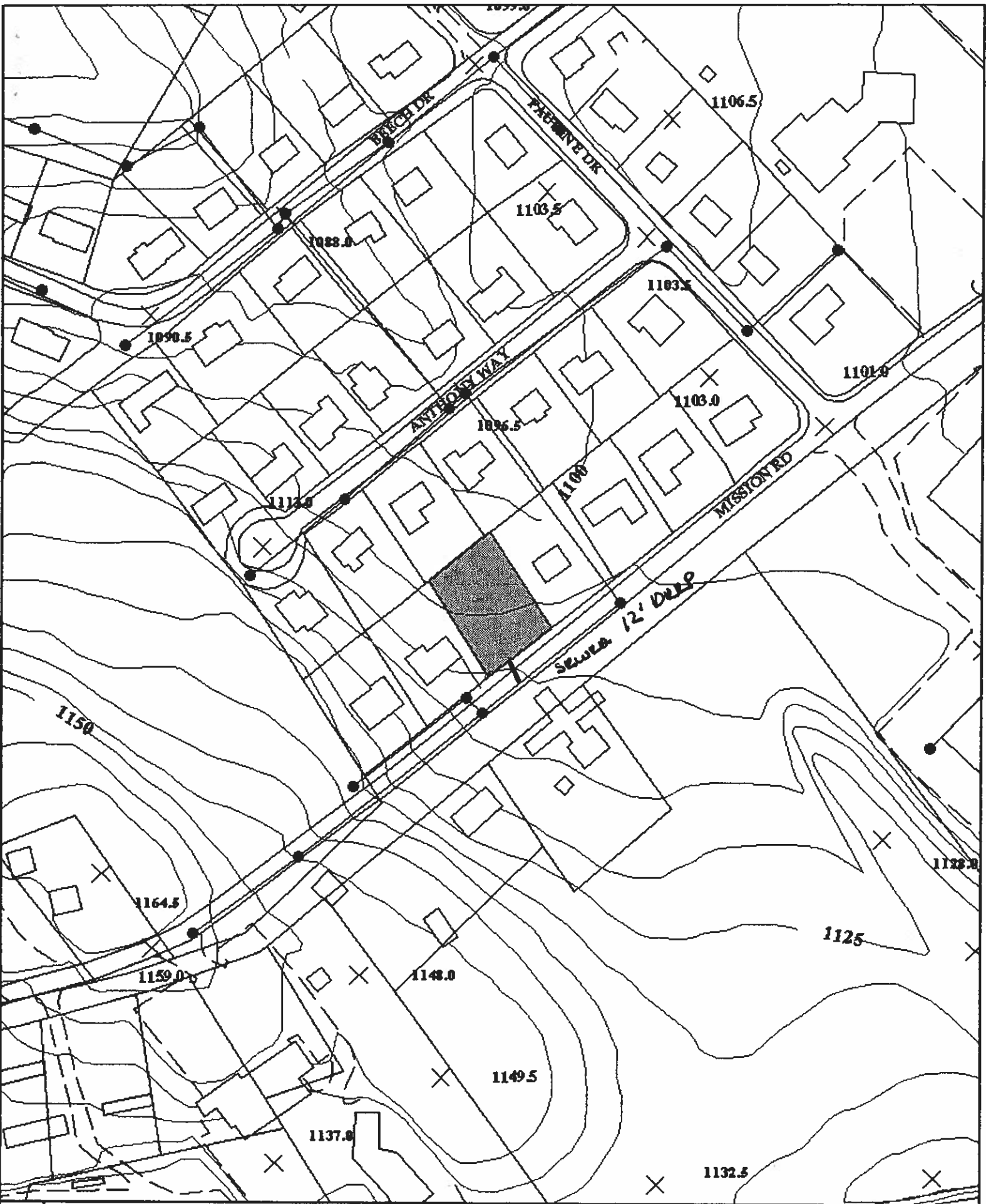

Map Title Goes Here



TAK 61-14-13-0-021

RITA A. KUBA
CHRIS E. BIVENS
3029 BETHANY LANE
ELLCOTT CITY, MD 21042

125

December 9, 2008
Date

7-7063/2520
08

Pay to the Order of UTMA \$ 2650.00

two thousand six hundred fifty and XX / 100 Dollars

Security Features Details on Back

EASTERN
SAVINGS BANK

Established 1905

HUNT VALLEY, MD 21031

For Tap-in Fee 61-14-130-021

CEY

MP

⑆ 25 20 7063 9 ⑆ 08 57004371 ⑆ 0125

Harland Clark

ETCHINGS CUSTOM CREATIONS